







# Art. 01 02



**TESTA A PIALLARE  
ELICOIDALE CON COLTELLI A 35°**   
**SPIRAL PLANER HEADS  
WITH 35° INSERTS**   
**PORTE-OUTILS DE RABOTAGE  
HÉLICIODAUX PLAQUETTES 35°**   
**SPIRALHOBELKÖPFE  
MIT 35° WENDESCHNEIDEN**   
**CABEZALES PARA CEPILLAR HELICOIDALES  
CON CUCHILLAS A 35°**   
**СПИРАЛЬНЫЕ СТРОГАЛЬНЫЕ ГОЛОВКИ С  
НОЖАМИ 35°** 

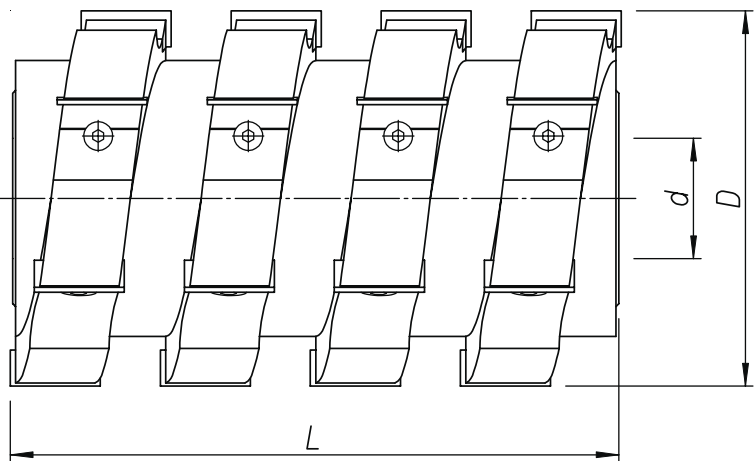
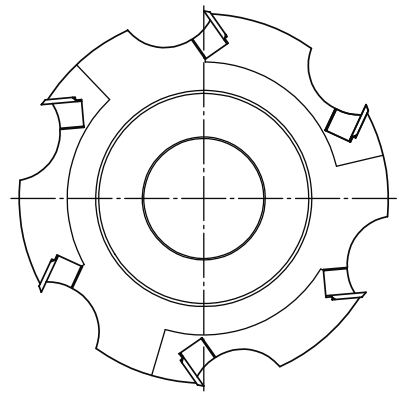

Cod. Acciaio Steel	Cod. Lega Light Alloy	D	L	d	Z	RPM max
100 125 00	100 125 10	100	125	30→40	15	10500
100 153 00	100 153 10	100	153	30→40	18	10500
100 183 00	100 183 10	100	183	30→40	21	10500
100 205 00	100 205 10	100	205	30→40	24	10500
100 223 00	100 223 10	100	223	30→40	24	10500
100 235 00	100 235 10	100	235	30→40	27	10500
125 125 00	125 125 10	125	125	30→50	15	9100
125 153 00	125 153 10	125	153	30→50	18	9100
125 183 00	125 183 10	125	183	30→50	21	9100
125 205 00	125 205 10	125	205	30→50	24	9100
125 223 00	125 223 10	125	223	30→50	24	9100
125 235 00	125 235 10	125	235	30→50	27	9100
140 125 00	140 125 10	140	125	30→50	15	7700
140 153 00	140 153 10	140	153	30→50	18	7700
140 183 00	140 183 10	140	183	30→50	21	7700
140 205 00	140 205 10	140	205	30→50	24	7700
140 223 00	140 223 10	140	223	30→50	24	7700
140 235 00	140 235 10	140	235	30→50	27	7700

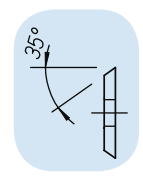

## Ricambi-Spare Parts

Descrizione-Description	Dimensione-Dimension	Codice-Code
Coltello-Knive	30x12x1,5 35°	I10.05
Tassello-Wedge	23,5	I10.05/T
Vite-Screw (D=100)	M7x18	V13.7/18CE
Vite-Screw (D >100)	M7x24	V13.7/24.6CE

