

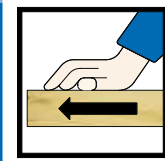





# Art. 05 02



-  **FRESA PER GIUNZIONI MINIZINKEN REGISTRABILE**
-  **MINIZINKEN GLUE JOINT CUTTERS, ADJUSTABLE**
-  **PORTE-OUTILS MINI-ABOUTAGE**
-  **MINIZINKEN-MESSERKÖPFE, VERSTELLBAR**
-  **FRESA PARA UNIONES DE TESTA DE 45 A 90 mm**
-  **ФРЕЗА ДЛЯ СОЕДИНЕНИЯ НА МИНИШИП С ЗАКРЫТЫМ КЛЕЕВЫМ ШВОМ (B 45-90мм)**

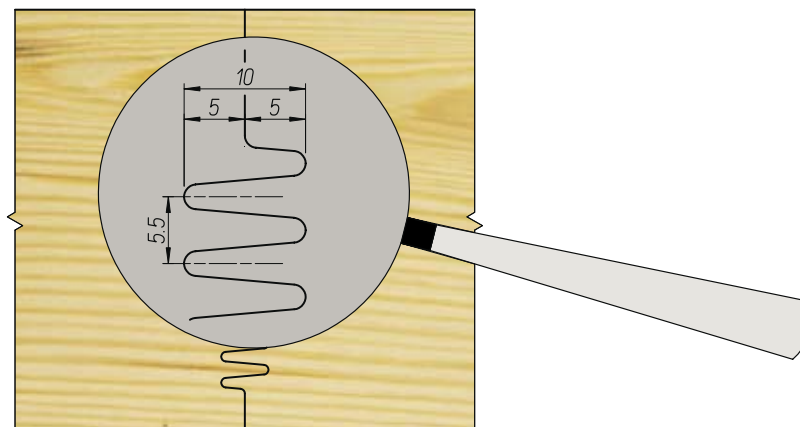
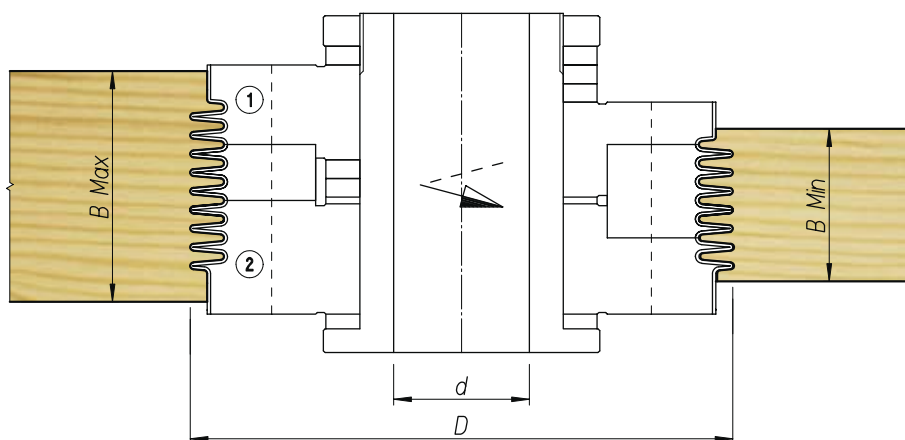
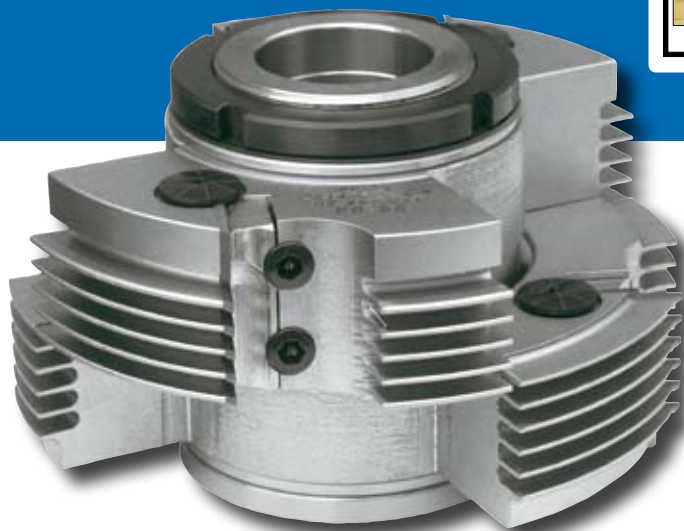

## Ricambi-Spare Parts

Cod.	D	B	d	Z	RPM max
160 459 00	160	45÷90	30→50	2+2	7100
320 459 00	320	45÷90	30→50	2+2	4300

Descrizione-Description	Dimensione-Dimension	Codice-Code
Coltello-Knive	50mm (1)	I60.S0929AD
Tassello-Wedge	(1)	I60.S0929AD/T
Coltello-Knive	50mm(2)	I60.S0929BD
Tassello-Wedge	(2)	I60.S0929BD/T
Vite-Screw	M7x24	V13.7/24.6CE
Fermo-Allen Head	M8x12 Ø18	V18.8/12/18

**VIVALDI**